



INSTALLATION AND OPERATING INSTRUCTIONS
for
Safety Pilot Kit (FSP-10) and (FSP-10-SS)
for Gas Log Sets (LP or Natural)

IMPORTANT: READ INSTRUCTIONS CAREFULLY BEFORE BEGINNING INSTALLATION.

This safety pilot kit contains a control certified by C.S.A.

DAMPER MUST BE FULLY OPEN WHEN LOG SET IS OPERATING.

FOR YOUR SAFETY
WHAT TO DO IF YOU SMELL GAS

- Do not try to light any appliance.
- Do not touch any electrical switch; do not use any phone in your building.
- Immediately call your gas supplier from a neighbor's phone. Follow the gas supplier's instructions.
- If you cannot reach your gas supplier, call the fire department.

FOR YOUR SAFETY

Do not store or use gasoline or other flammable vapors and liquids in the vicinity of this or any other appliance.

WARNING: Improper installation, adjustment, alteration, service or maintenance can cause injury or property damage. For assistance or additional information, consult a qualified installer, service agency or the gas supplier.

LOCATE THE INSTRUCTIONS THAT CAME WITH YOUR BURNER BEFORE INSTALLING SAFETY PILOT. THE BURNER INSTRUCTIONS HAVE RELATED INFORMATION FOR THE PROPER INSTALLATION OF THE SAFETY PILOT.

HOW TO ASSEMBLE YOUR SAFETY PILOT KIT

This kit must be installed by a qualified person. Instructions must be followed carefully during installation to ensure proper performance and safety.

These instructions must be used as a supplement to the instructions that were supplied with your burner unit. Follow the instructions supplied with your burner and make adjustments as needed for the addition of the safety pilot. Gas supply must be a 1/2" minimum I.D. and with correct pressure.

ASSEMBLY INSTRUCTIONS FOR SAFETY PILOT

NOTE: Please note the small brown envelope packed with the pilot kit. If it is marked LP GAS the pilot orifice in the pilot burner is for Natural gas. If you are installing this pilot kit on LP gas the Natural gas pilot orifice will have to be removed and the LP gas pilot orifice installed in the pilot burner.

NOTE: Use pipe sealing compound on all male threads except brass to brass connections. Ensure that all connections are tight.

1. Screw elbow (Item 4) into valve (Item 11) at the port that is nearest to the stem end. NOTE: This will be the outlet port of the valve. The inlet port located toward the back of the valve will have a spring visible in the port.
2. Screw adaptor (Item 3) into elbow (Item 4).
3. Screw valve assembly (Items 3,4 and 11) onto the burner orifice or air mixer (Item 2 supplied with the burner unit). Ensure that the knob or handle is facing the front of the unit after the control valve is tight.
4. Install pilot (Item 9) and thermocouple to valve. Attach the aluminum pilot line coming from the pilot head (Item 9) to the pilot outlet on the valve. (The pilot outlet on the valve is the brass threads facing the back of the valve). Attach the brass line coming from the thermocouple to the aluminum valve head located on the rear of the valve body. Finger tighten only, then turn 1/8 turn with wrench. Do not over tighten or the pilot will not work.
5. Install sheet metal nut (item 14) on brass fitting (item 15). Screw nut as far as possible onto the fitting. Before proceeding, please note as to the insulation pad (item 12) and the heat shield (item 13): You will need to cut a hole in the valve insulation pad that (item 12) will match the hole in the heat shield. Note the brass fitting (item 14) goes through the insulation pad to hold it in place.
6. Install the valve insulation pad (item 12) over the valve (item 11).
7. Place heat shield (item 13) on control valve so that the hole in the shield is in line with the inlet hole in the control valve and the shield is on the burner pan side of the control.
8. Screw brass fitting (item 15) through heat shield (item 13) and into control valve (item 11) and tighten brass fitting. After brass fitting is tightened, it should face the rear of the unit.
9. Tighten locknut (item 14) to secure heat shield.
10. Install pilot assembly to burner pan with provided screws. (See FIG. 1) Small white insulation pad (item 8) must be placed between pilot assembly and pilot mounting tab on burner pan.
11. Gas supply line is attached to brass fitting (item 15).

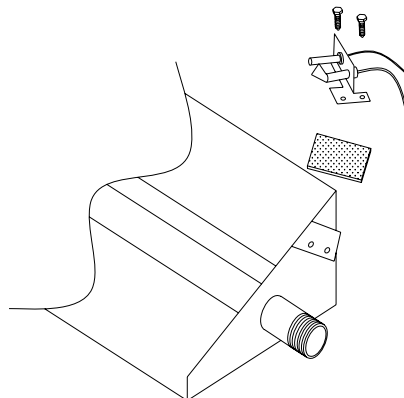
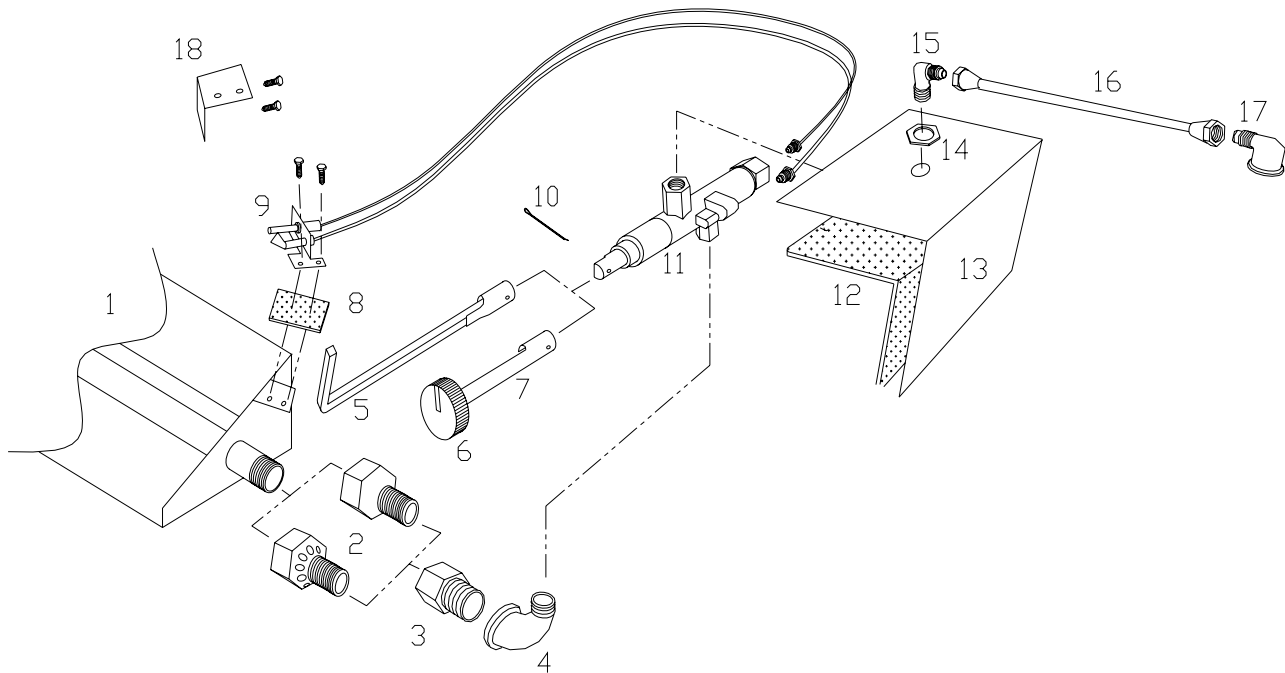

FIGURE 1

PARTS LIST FOR FSP-10 & FSP-10-SS



ITEM NUMBER	PART NUMBER	DESCRIPTION
1		Burner Pan
2	AM-2	Air Mixer (Supplied with burner)
	BPO-2	Fuel Injector (Supplied with burner)
3	07-1001	3/8" Adapter
4	07-1020	3/8" Street Elbow
5	07-1019	Rod Handle
6	07-1030	Valve Knob
7	07-1002	Stem Extension
8	10-1041	Insulation Pad 1 1/4" x 1 1/2"
9	07-1009	Thermocouple
	07-1008	Pilot Assembly
10	01-1078	Cotter Pin
11	07-1025	Control Valve
12	07-1007	Insulation Pad 4" x 5"
13	07-1005	Heat Shield
	MT-700-HSSS	Heat Shield (Used on Stainless burners Only)
14	07-1018	Sheet Metal Nut
15	11-1300	3/8" Brass Elbow
16	FT-4	Tubing with 3/8" Nuts (Supplied with burner)
17	10-1037	3/8" Elbow Brass (Supplied with burner)
18	MT-700-PB	Pilot Bracket (Used on 36 & 40 Burner Only)
	MT-700-PBSS	Pilot Bracket (Used on DGSS Only)

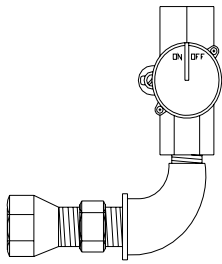

FIG. 2
OFF

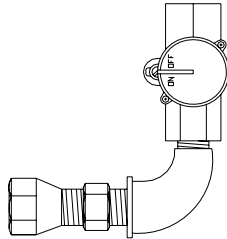
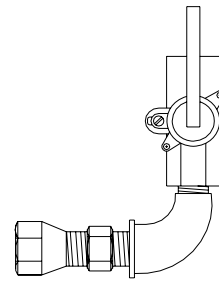

FIG. 3
PILOT

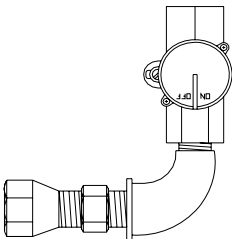
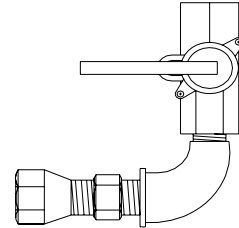
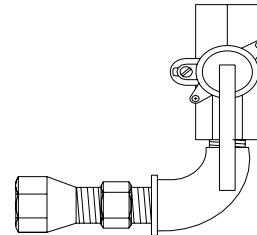
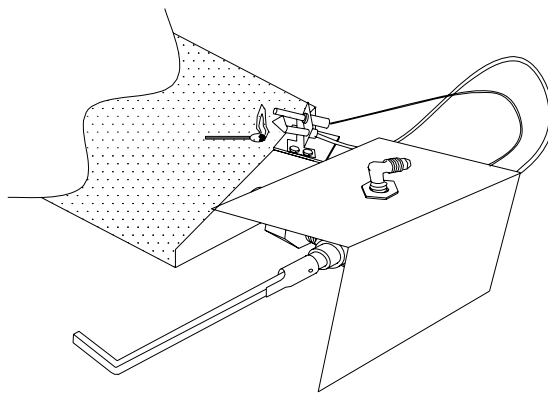

FIG. 4
ON



HOW TO LIGHT PILOT

With knob at the PILOT position, push knob or rod handle in slightly and rotate to the OFF position (FIG. 2). Wait five (5) minutes, then turn knob or rod handle to the PILOT position (FIG. 3). Push the knob or rod handle in (this starts the gas flow) and at the same time place a lit match at the pilot burner. Once the pilot lights, continue to depress the knob or rod handle for 1 minute. After 1 minute, slowly release knob or handle and the pilot should remain lit. If pilot does not remain lit, rotate knob or handle to OFF position (FIG. 2). Wait five minutes and repeat above steps.



HOW TO TURN LOG SET ON AND OFF

Ensure that the damper is fully open when operating the gas log set. To turn on gas log set from the pilot position (FIG. 3), turn the knob or handle counterclockwise to the ON position (FIG. 4).

To turn the gas log set off, rotate knob or rod handle clockwise to the PILOT position. At this point, the pilot will continue to burn, but the main burner will not.

To turn the pilot off, push in slightly and rotate knob or handle clockwise to the OFF position (FIG. 2).

PILOT FLAME ADJUSTMENT

The pilot flame adjustment screw is located on the front side of the pilot gas tubing port. (See diagram below.) Using a small straight slot screwdriver, turn the screw clockwise to adjust the pilot flame down and counterclockwise to adjust the pilot flame up. This screw is sensitive, therefore it will not take much adjustment to accomplish the flame adjustment.

If the screw is turned clockwise until it stops, then turn the screw counterclockwise 1/2 turn. This should be a good beginning point for the pilot flame.

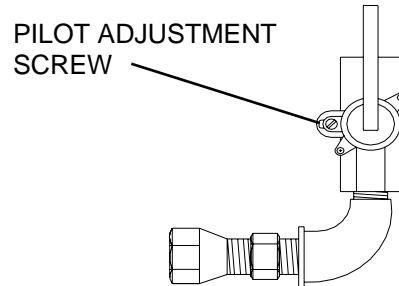
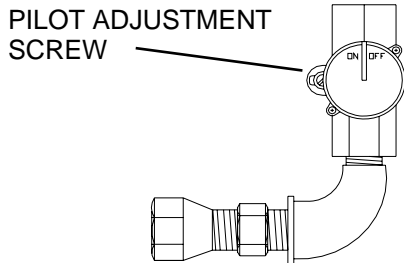

COTTER PIN INSTALLATION

1. Slide handle extension on to the valve.
2. Line up hole through handle & valve stem.
3. Insert cotter pin.
4. Bend back the ends of the cotter pin to keep it from coming out.

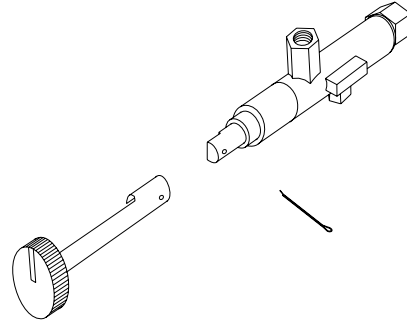
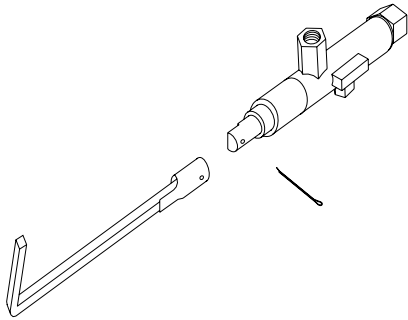

**HEATMASTER, LLC.
LIMITED WARRANTY**

All refractory cement logs manufactured by Heatmaster LLC. have a lifetime warranty against breakage due to heat to the original owner in the original installation.

All other logs supplied from Heatmaster LLC. have a 2 year warranty against breakage due to heat to the original owner in the original installation.

All metal parts, including burners and grate assemblies, are warranted for 5 years.

All other mechanical parts are warranted for 1 year.

LIMITATIONS

1. Heatmaster, LLC.'s obligations to the purchaser under this warranty are limited to the repair or replacement of defective part.
2. Repairs or replacement will be performed by Heatmaster, LLC. following delivery of the product by the purchaser to Heatmaster, LLC.'s facility in Angier, North Carolina. The cost of mailing or other delivery to Heatmaster, LLC. shall be borne by the purchaser. The mailing address is: Heatmaster, LLC., 3625 Benson Rd., Angier, NC 27501.
3. Along with the product, the purchaser shall include a written explanation of the approximate date the product was purchased, the dealer or person from whom the product was purchased, the date the defect was first noticed, a description of the nature of the defect, and what the purchaser did, if anything, to repair or correct the defect.
4. To the extent allowed by law, any **implied warranty of merchantability of fitness** applicable to this product is limited to the duration of this warranty. Heatmaster, LLC. shall not be liable for loss of use of this product, loss of time, inconvenience, commercial loss or consequential damages. The remedy of repair or replacement of a defective part during the warranty period herein specified shall be the purchasers exclusive remedy.
5. Heatmaster, LLC. is not responsible for any loss or damages caused by purchaser's failure to follow operating & maintenance instructions provided in owners manual.

Dear Purchaser:

We are pleased that you have selected our product and take this opportunity to assure you that qualified service is available if required.

Please Review & Complete The Enclosed Warranty/Registration Card

Who gets the warranty?	The warranty is limited to the consumer who originally purchased the product.
What is covered?	This limited warranty covers all imperfections in workmanship and material.
What is not covered?	This limited warranty does not cover damage resulting from accident, misuse or abuse, lack of proper maintenance, affixing of any attachments not provided with the products, or loss of parts. IN NO EVENT SHALL HEATMASTER, LLC. BE LIABLE FOR ANY SPECIAL, INCIDENTAL OR CONSEQUENTIAL DAMAGES RESULTING FROM MISUSE OR MODIFICATION OF THIS PRODUCT.

DEFECTIVE PARTS OR BROKEN LOGS FOR REPLACEMENT MUST BE RETURNED TO THE FACTORY PREPAID ALONG WITH PROOF OF PURCHASE. FACTORY WILL REPAIR OR REPLACE AT FACTORY OPTION AND RETURN TO PURCHASER FREIGHT PREPAID.